

MF16
MONKEY FAN 16W



MF020
MONKEY FAN 20W



MF30
MONKEY FAN 30W



CAUTION (MF020)

SPACE BOOSTER

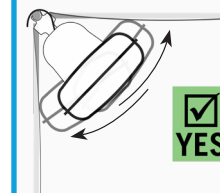
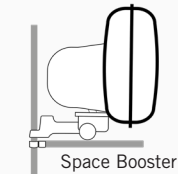

With
Space Booster

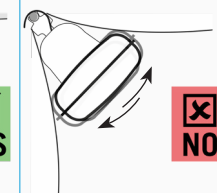

Without
Space Booster



CABLE POSITION

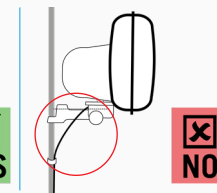
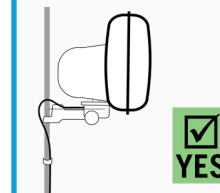

DURABILITY IN CLEAN ENVIRONMENT (LIFE TIME)

24/24h = 6 months

12/24h = 12 months

6/24h = 24 months

MONKEY FAN			WGT	DIM NET			DIAMETER		SPEED		WIND SPEED		MAIN POWER				TEMPERATURE		
REF	DESIGNATION METRIC	REV	Net kg	w cm	h cm	d cm	Fan cm	Screw cm	#	Max rpm	Dist cm	Speed m/s	Voltage V	Freq. Hz	Power Watts	Cable L (cm)	Plug Type	Working Min-Max	Storing Min-Max
MF16UE	Monkey Fan 16W UE	R2.00	0,6	19,5	20,0	20,0	19,0	15,2	2	2250	70 cm	1,8	220V	50	16w	240	C Type (UE)	15 to 35°C	0 to 50°C
MF16UK	Monkey Fan 16W UK	R2.00	0,6	19,5	20,0	20,0	19,0	15,2	2	2250	70 cm	1,8	220V	50	16w	240	G Type (UK)	15 to 35°C	0 to 50°C
MFO20UE	Monkey Fan 20W Oscillating UE	R2.00	1,0	21,0	20,0	21,0	21,0	16,8	2	2300	70 cm	2,0	220V	50	20w	240	C Type (UE)	15 to 35°C	0 to 50°C
MFO20UK	Monkey Fan 20W Oscillating UK	R2.00	1,0	21,0	20,0	21,0	21,0	16,8	2	2300	70 cm	2,0	220V	50	20w	240	G Type (UK)	15 to 35°C	0 to 50°C
MF30UE	Monkey Fan 30W UE	R2.00	1,1	28,0	15,0	25,5	23,0	17,8	2	2300	70 cm	3,7	220V	50	30w	240	C Type (UE)	15 to 35°C	0 to 50°C
MF30UK	Monkey Fan 30W UK	R2.00	1,1	28,0	15,0	25,5	23,0	17,8	2	2300	70 cm	3,7	220V	50	30w	240	G Type (UK)	15 to 35°C	0 to 50°C

MF16
MONKEY FAN 16W



MF020
MONKEY FAN 20W



MF30
MONKEY FAN 30W



CAUTION (MF020)

SPACE BOOSTER

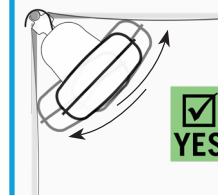
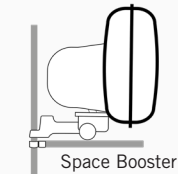

With Space Booster

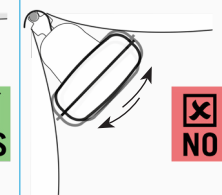

Without Space Booster

CABLE POSITION

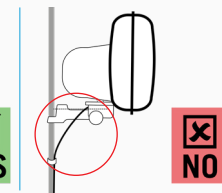
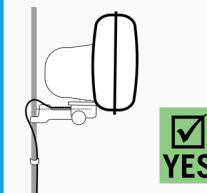

DURABILITY IN CLEAN ENVIRONMENT (LIFE TIME)

24/24h = 6 months

12/24h = 12 months

6/24h = 24 months

MONKEY FAN			WGT	DIM NET			DIAMETER		SPEED		WIND SPEED		MAIN POWER			TEMPERATURE			
REF	DESIGNATION IMPERIAL	REV	Net lb	w in	h in	d in	Fan in	Screw in	#	Max rpm	Dist in	Speed ft/s	Voltage V	Freq. Hz	Power Watts	Cable L (in)	Plug Type	Working Min-Max	Storing Min-Max
MF16UE	Monkey Fan 16W UE	R2.00	1,3	7,7	7,9	7,9	7,5	6,0	2	2250	30 in	5,9	220V	50	16w	95	C Type (UE)	60 to 95°F	30 to 120°F
MF16US	Monkey Fan 16W US	R2.00	1,3	7,7	7,9	7,9	7,5	6,0	2	2250	30 in	5,9	110V	60	16w	95	A Type (US)	60 to 95°F	30 to 120°F
MFO20UE	Monkey Fan 20W Oscillating UE	R2.00	2,2	8,3	7,9	8,3	8,3	6,6	2	2300	30 in	6,6	220V	50	20w	95	C Type (UE)	60 to 95°F	30 to 120°F
MFO20US	Monkey Fan 20W Oscillating US	R2.00	2,2	8,3	7,9	8,3	8,3	6,6	2	2300	30 in	6,6	110V	60	20w	95	A Type (US)	60 to 95°F	30 to 120°F
MF30UE	Monkey Fan 30W UE	R2.00	2,4	11,0	5,9	10,0	9,1	7,0	2	2300	30 in	12,1	220V	50	30w	95	C Type (UE)	60 to 95°F	30 to 120°F
MF30US	Monkey Fan 30W US	R2.00	2,4	11,0	5,9	10,0	9,1	7,0	2	2300	30 in	12,1	110V	60	30w	95	A Type (US)	60 to 95°F	30 to 120°F

